

Carwash Range



SUZOHAPP

SUZOHAPP is a technology company providing software and hardware for cash handling automation and self-service solutions to more than 25,000 customers throughout the world. SUZOHAPP's technology enables automation for customers operating in a variety of end markets including retail, transportation, gaming, banking, vending and amusement. SUZOHAPP's solutions include cash deposit, recycling, processing and payment systems as well as a broad range of self-service component technologies. SUZOHAPP's more than 1,100 employees operate in 18 countries and dealer network covers more than 100 countries. The brands of SCAN COIN, Comestero and CashComplete™ are united under the SUZOHAPP Company.

SUZOHAPP's mission is to provide its customers with excellent service and high quality components, solutions, and software that create significant value for their business. The company vision is to become the global market leader by being true to its core value of growth through the investment in people and innovation and so providing market-leading solutions for all the customers in all the markets throughout the world.

SUZOHAPP is owned by affiliates of ACON Investments, L.L.C., a Washington, D.C.- based international private equity investment firm that has responsibility for managing approximately \$4.4 billion of capital.



 **34 FACILITIES**
18 COUNTRIES

 **1,100+**
EMPLOYEES

 **115 ENGINEERS**

 **50,000+**
PRODUCTS

 **5,000+ SOLUTIONS**
6M+ DEVICES

 **25,000+**
CUSTOMERS

Index

Solutions

Car wash starters and change machines

Pit PRO	page 6
Multi PRO	page 8
Touch PRO	page 10
MyScan	page 12
MyPOS	page 13
Pit Start Plus	page 14

Components

Electronic coin validators

RM5 Evolution	page 16
RM5 HD	page 18

Cashless systems

EuroKey Next	page 20
WorldKey	page 22
Easy Pay	page 26

Accessories

Electronic Boards and control device	page 27
Tokens	page 28

Pit PRO

High-end entry level

Designed for outdoor use, it can manage up to 8 different washing programs, change money or tokens and recharge keys or cards. The new heavy-duty structure is specifically designed to resist dust, splashes of water and sprayed chemicals. The solid and compact structure with a front door is suitable for all installations, free-standing or built-in.



Features

- Designed to satisfy each need: an only system to activate the car wash station, buy tokens, recharge keys or card
- User-friendly 5" touch screen
- Vocal guide
- Possibility of paying in coins, banknotes, bankcards or card/key, thanks to the installed cashless system
- Possibility of recharging keys and cards
- Rapidly change banknotes into coins and/or coins into tokens
- Issuing a receipt once a transaction is completed or in case of a malfunction
- Possibility of a remote connection to the machine to update and configure it
- Automatic alarms email
- Automatic accounting email
- Barcode reader
- Locktable door whit 10 closing points
- Installation flexibility: free-standing or wall-mounted
- Structure resistant to esternal agents
- MaxiBIO board to manage carwash facilities

Technical Schematics

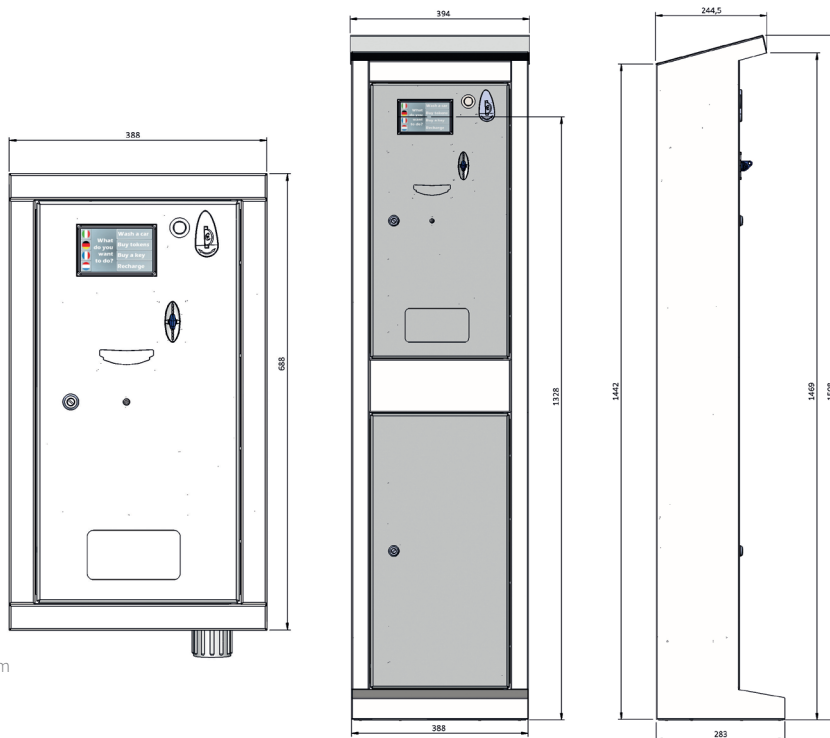

Note: Unit of measure mm

Installed peripherals

- Proximity sensor
- Anti-vandal 5" touch screen
- Vocal guide

Optional peripherals

- RM5 HD coin validator
- Currenza C² coin recycler (as alternative to RM5 HD)
- NV9 USB banknote reader
- Cube Hopper + extension
- Scanner for barcodes and QR-codes
- EuroKey Next cashless system
- POS
- Thermal receipt printer



Technical specifications

	Free-standing	Wall-mounted
Dimensions (LxHxW)	394 x 1,508 x 283 mm	388 x 688 x 182.3 mm
Weight	52 Kg	17 Kg
Power supply voltage	24 Vac ±10%	24 Vac ±10%
Current consumption	25 W	25 W
Operating temperature	-15 °C - 50 °C humidity 10% - 90% uncondensed	-15 °C - 50 °C humidity 10% - 90% uncondensed

Coin Capacity

	0.5 €	1 €	2 €
1 Cube hopper with extension	700	700	500

Multi PRO

Quality, technology and safety in a single product

Latest technology, touch screen monitor and advanced functions for Multi PRO, the revolutionary starter for portals and outdoor change machines, designed with the aim of meeting the operator requirements and combining innovation, simplicity and convenience. Multi PRO manages up to 8 washing programs via a practical 5" touch screen monitor and a vocal guide. Based on state-of-the-art PC architecture, it support the user to quickly manage multiple tasks, such as starting the washing program, recharge cards and keys, change money, buy tokens and distribute cards or keys. The cabinet has been redesigned from a mechanical aspect to provide robustness and convenience. The machine is available free-standing or wall-mounted.



Features

- Integrated and complete control of the entire carwash portal. A single point to activate the carwash, pay, recharge cards/keys, change money, distribute keys/cards and buy tokens or cards/keys
- Possibility of paying with coins and banknotes or a card or key/card. If required, payment can be made with bankcards (chip or contactless)
- Rapidly change banknotes into coins and/or coins into tokens
- Sell tokens with 3 separate hoppers
- Give change in coins and banknotes
- Recharge credit on keys or cards
- Dispense cards and keys
- Print the receipt once the transaction is complete or if unsuccessful
- Management of promotional activities to purchase tokens or recharge keys or cards
- Vocal and graphic support
- Touch screen interface for fast and simplified operations
- Possibility of a remote connection to update and configure it
- Automatic accounting emails
- Automatic alarms emails
- Barcode reader
- Installation flexibility: free-standing or wall-mounted
- Structure resistant to external agents: water, dust and various types of atmospheric agents

Technical Schematics

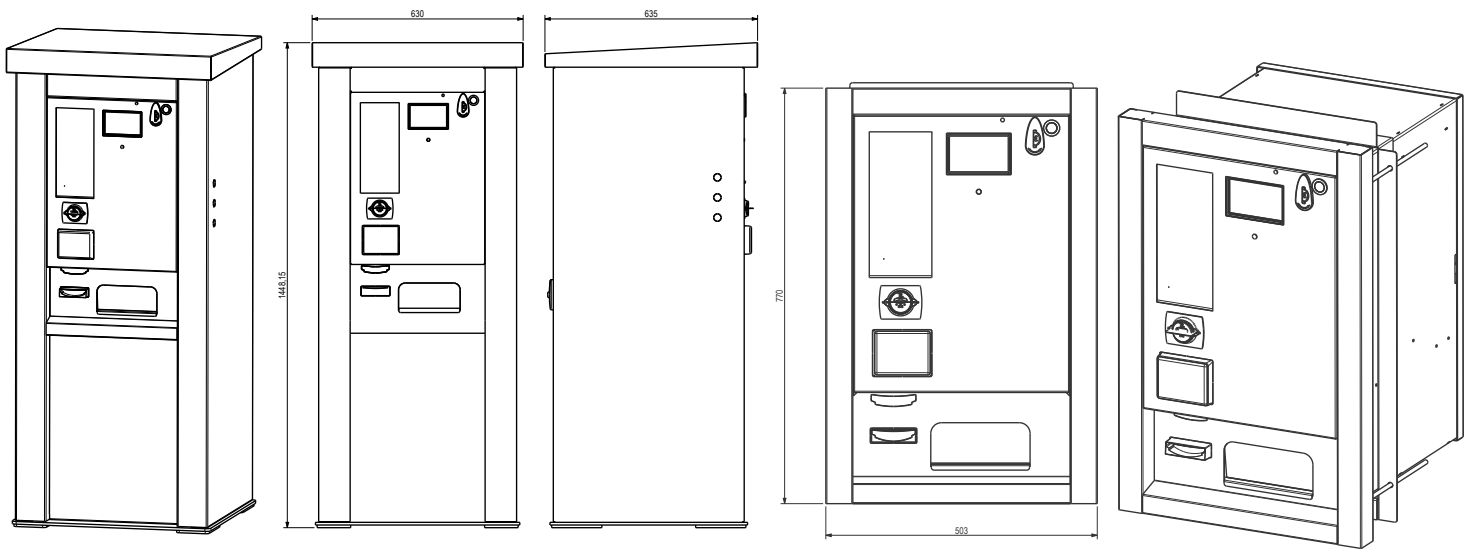

Note: Unit of measure mm

Installed peripherals

- Anti vandal 5" touch screen
- Vocal guide
- Proximity sensor

Optional peripherals

- RM5 HD coin validator
- Currenza C² coin recycler (instead of RM5 HD)
- EuroKey Next cashless system
- 2 dispensers of cards or keys
- 2 NV9 USB banknote readers
- NV11 USB banknote recycler (as alternative to NV9 USB)
- 3 Evolution hoppers
- POS
- Bankcard contactless reader
- Scanner for the barcode management
- Thermal receipt printer
- Fiscal printer for eastern countries



Technical specifications

	Free-standing	Wall-mounted
Dimensions (LxHxD)	630 x 1,448.15 x 590	503 x 770 x 518 mm
Weight	140 Kg	70 kg
Power supply voltage	230 Vac	230 Vac
Current consumption	230 VA	230 VA
Operating temperature	-15°C to 50°C humidity 10% to 90% not condensed	-15°C to 50°C humidity 10% to 90% not condensed

Coin Capacity

	0.5 €	1 €	2 €
1 Evolution hopper	1,500	1,500	1,200
2 Evolution hoppers	3,000	3,000	2,400
3 Evolution hoppers	4,500	4,500	3,600

Touch PRO

The best technology blends together with ease of use and profitability

Touch PRO is much more than just a portal starter. Its state of the art technology offers numerous advantages to both the user and the operator. Its practical, wide anti-vandal touch screen and payment systems are grouped together to be immediately recognisable and give accessible result in greater ease of use. Its several implemented functions, on the other hand, allow the operator to increase the business day after day. Touch PRO is not just a simple centralised cash point but a truly automated car wash service support and a powerful marketing tool. It manages of up to 8 different services and dispense complementary products, such as tokens and cards.



Features

- User friendly touch screen interface easy sales operations as well as accounting data configuration and collection
- Graphic and vocal support guiding the user through various operations
- Possibility to pay by cash as well as with tokens, cards, keys or by credit card (in countries where this service is available)
- Change is given
- Keys, cards, or tokens (associated with a service) dispensing
- Barcode scanning for an automated management of promotions, bonuses and discounts
- Incentive to purchase a program of higher price/quality to increase sales
- Possibility to print limited time promotional tickets to increase the frequency of visits
- Promotional campaign management through discounts and special offers
- Refund receipt in the event of failed service provision or machine malfunction
- Differentiated pricing per payment method (cash or cashless)
- Alarm messages and accounting data via e-mail sending
- Automatic print of daily accounting reports by means of a special barcode
- Possibility to print or export of accounting data and marketing information in .csv format
- Direct phone calls through a dedicated line (optional)

Technical Schematics

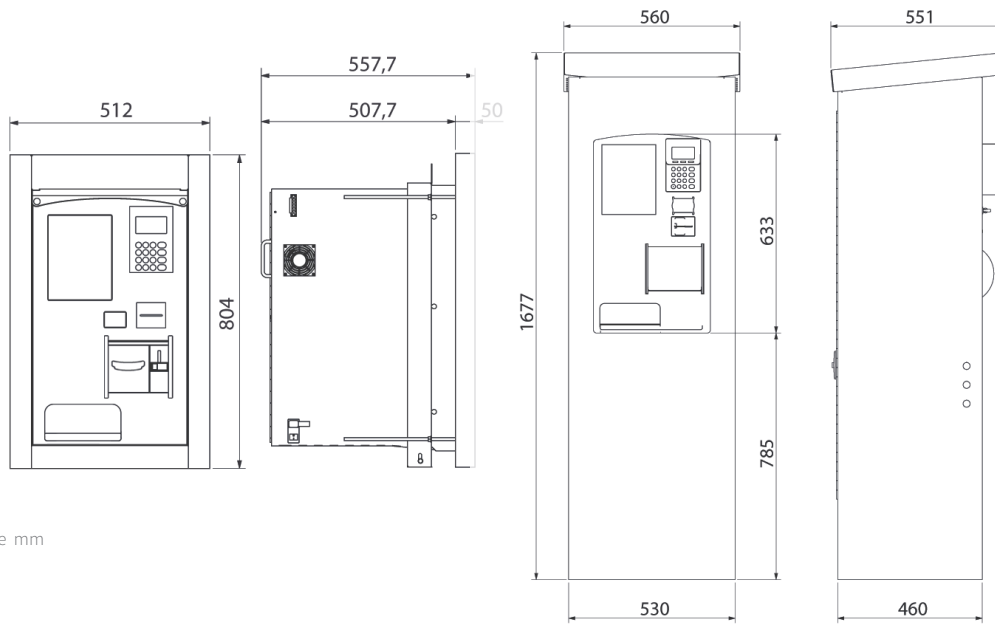

Note: Unit of measure mm

Tools

TouchConfig

Innovative integrated program suitable for a complete starter configuration, which allows the importing and exporting of total and partial accounting data

TouchCompta

Program suitable for consulting, analysing, exporting and printing machine accounting data. Possibility to set search filters to obtain all the statistics linked to marketing operations. Data access is controlled and protected by hierarchical passwords

Optional accessories

- “Accessible” cabinet
- Standard cabinet
- Luminous sign for customisable standard cabinet

Installed peripheral devices

- RM5 HD electronic coin mechanism
- Barcode and QR code scanner
- Thermal receipt printer

Optional peripheral devices

- NV9 USB banknote reader
- Evolution hopper
- 2nd Evolution hopper
- EuroKey Next cashless system
- Card dispenser
- Key dispenser
- Telephone call kit for dedicated line
- POS module (available in the countries that use it)

Technical specifications

Accessible cabinet-mounted starter

Wall-mounted starter

Dimensions (LxHxD)	560 x 1.677 x 551 mm	512 x 804 x 562,7 mm
Weight	81 Kg	53 Kg
Supply voltage	230 Vac	230 Vac
Current consumption	230 VA	230 VA
Operating temperature	-15 °C - 50 °C humidity 10% - 90% uncondensed	-15 °C - 50 °C humidity 10% - 90% uncondensed

Internet connection required to guarantee the proper functioning of the starter

Coin capacity

	0.5 €	1 €	2 €
1 Evolution hopper	1,500	1,500	1,200
2 Evolution hopper	3,000	3,000	2,400

MyScan

Easy activation system

MyScan is the result of the combination between MyService and a 2D scanner. Based on MyService box, it automates the payment of several timed services, such as service areas, self-service laundries, sport and tourist facilities, public services and timed lighting, simply by scanning a QR Code ticket.

Features

- Automatic service activation by scanning a QR-code ticket: printing tools can be the Easy Pay unit (desktop solution) or the Touch PRO machine (unattended solution)
- Management and automation up to 8 services
- Accounting data management



Technical Schematics

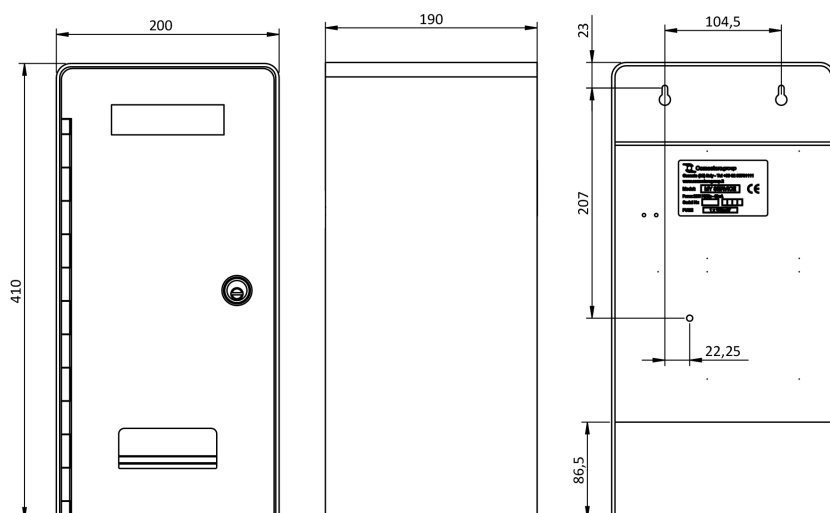

Note: Unit of measure mm

Technical specifications

Dimensions (LxHxD)	200 x 410 x 190 mm
Weight	8.5 Kg
Mounting	Wall-mount
Input voltage	230 Vac \pm 10%
Power consumption	40 W
Outputs	Relay, current-carrying capacity 4A at 230 Vdc
Humidity (non condensed)	90%
Storage temperature	-20° C \div 70° C



MyPOS

Simple bankcard payment solution

MyPOS is the result of the combination between MyService and a POS system. Based on MyService box, it automates the payment of several services, such as service areas, self-service laundries, sport and tourist facilities, public services and timed lighting, paying by bank card.

Features

- Service activation by choosing a service number on the anti vandal keypad, and paying by bank card
- Compatible with most of the contactless bank card payment systems
- Management and automation up to 8 services
- Accounting data management



Technical Schematics

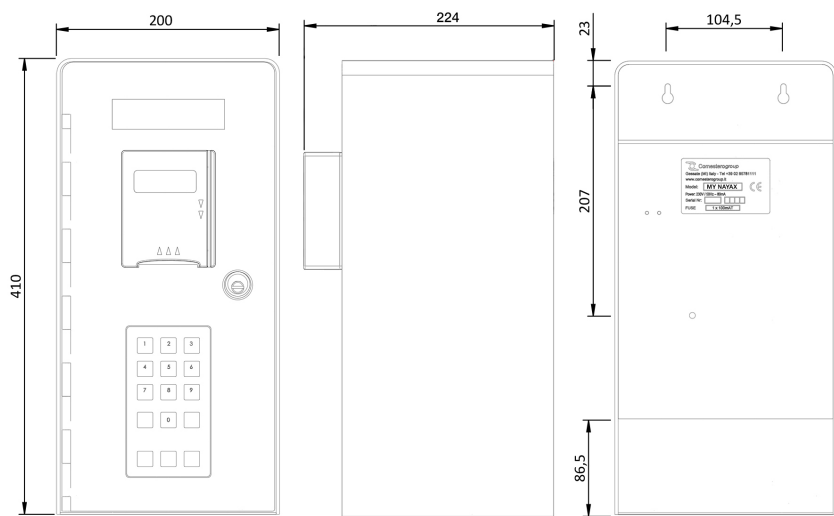

Note: Unit of measure mm



Ingenico contactless reader IUC180



P68 reader

Technical specifications

Dimensions (LxHxD)	200 x 410 x 224 mm
Weight	8.5 Kg
Mounting	Wall-mount
Input voltage	230 Vac ± 10%
Power consumption	40 W
Outputs	Relay, current-carrying capacity 4A at 230 Vdc
Humidity (non condensed)	90%
Storage temperature	-20° C ÷ 70° C

Pit Start Plus

The best unit for activating self-service washing bays

Specifically designed for self-service washing bays, it manages up to 7 wash programs through a single payment unit. It is particularly suitable for modernising existing high-pressure systems which still employ electro-mechanical control systems.

Solid and resistant, it guarantees excellent protection against dust, water jets and nebulised chemical products. Pit Start Plus is available in 2 different versions for easy installation on any type of system. The graphics label can be customised to increase the visibility of the company logo.



Features

- Coin entry protected by a mobile plate. Microchip card slot equipped with an internal waterproof seal
- IP 54 protection degree
- Stainless steel external frame, door and pushbutton panel
- Opening protected by a fully waterproof closing lock, equipped with an anti-drilling plate
- Transflective display, back-lit like the buttons, guaranteeing maximum visibility even in conditions of full sunlight
- 7 program selection buttons and 1 stop button to interrupt the service in progress
- Front panel with wide space for communicating with the user and for indicating the function of each button. Instructions shown on a customisable adhesive panel
- In the standard version, the interface is made with a DIN guide box equipped with 8 opto-isolated inputs for receiving signals from the system control unit, 8 relay outputs and 1 RS232 serial connector for programming the validator, transmitting accounting data and upgrading the software
- Possibility to set the prices on-field
- Installation:
 - wall mounted
 - free standing

Technical Schematics

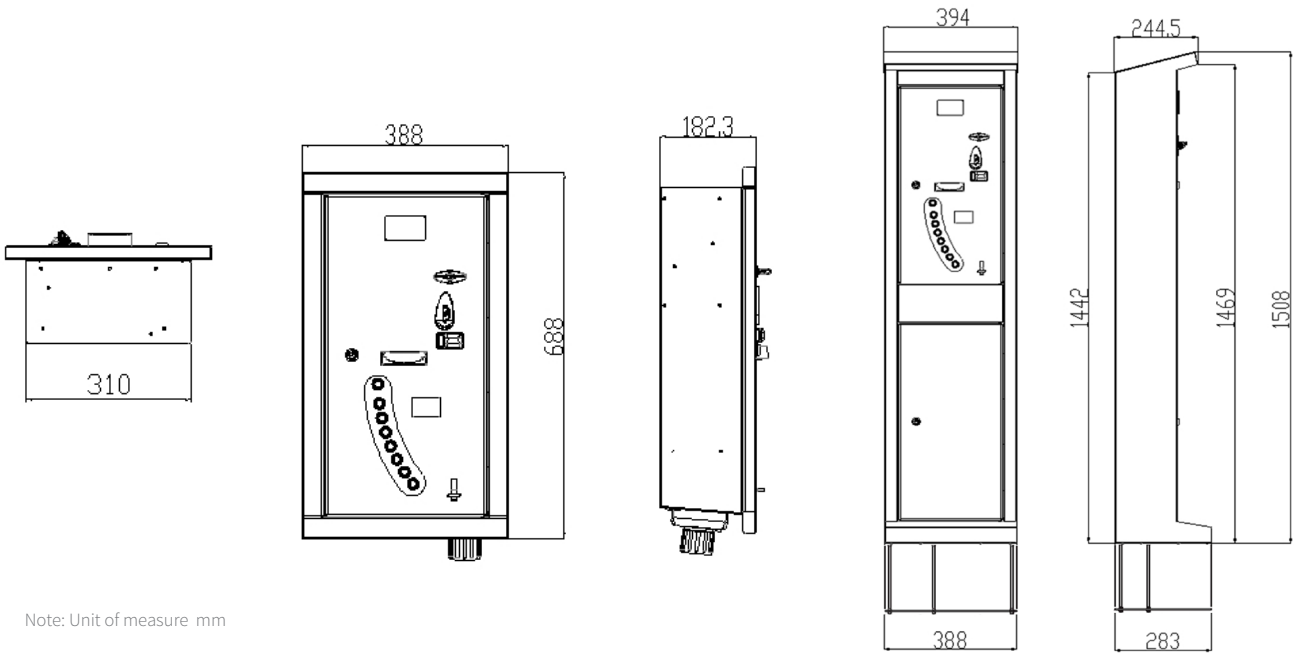

Note: Unit of measure mm

Functions

Stand-by status

When the cash unit is in stand-by, the display shows a message asking to insert cash and select a service, while the buttons light up in a rapid sequence in order to attract the customers' attention

Coin and token functionality

When the user inserts coins or tokens, the display will show the purchased credit. Once the first set price is reached, the Pit Start Plus will be ready to activate the corresponding service

Card or key operated

When the user inserts the key or the card, the display will show the amount of credit available. If the credit is equal to or higher than the lowest configured price, the Pit Start Plus is ready to activate the relative service

Selecting the services

Up to 7 different services can be selected, which correspond to an equal number of wash programs. The user can rapidly switch from one service to another by simply pressing the corresponding button

Installed peripherals

- RM5 HD electronic coin validator
- EuroKey Next cashless system

Optional peripherals

- NV9 USB banknote reader
- WorldKey cashless system

Optional accessories

- Graphics label customised by quantity



Technical specifications

	Free standing starter	Wall-mounted starter
Dimensions (LxHxW)	394 x 1,508 x 283 mm	388 x 688 x 182,3 mm
Weight	52 kg	17 kg
Power supply	24 Vac ±10%	24 Vac ±10%
Power consumption	25 W	25 W
Operating temperature	-15 °C ÷ 50 °C humidity 10% ÷ 90% non-condensed	-15 °C ÷ 50 °C humidity 10% ÷ 90% non-condensed

Coin Capacity

	0.5 €	1 €	2 €
Cash box	800	850	650

RM5 Evolution

The record-breaking coin validator

The RM5 Evolution coin validator is known for its undisputed quality and reliability. Its electronics combine extraordinary selectivity with extreme programming versatility: the Cloning system allows the transfer of the configuration parameters.



Features

- 3 pairs of inductive sensors for processing 6 different parameters regarding the material and the mass
- 3 pairs of optical sensors for determining the coin's diameter
- A mechanical anti-fishing device
- An electronic anti-fishing device
- An electronic anti "intrusion" device (only for version F)
- Wire cutting blade
- Automatic optical sensor compensation system for variations in temperature, voltage and lighting
- Identification channels: up to 59, each of which can be redirected to the outlets. The first 6 support Self-Prog mode
- Open collection outlets
- Serial interface for external connections (portable programmer or PC) for calibrating and testing, as well as for updating the value and operating parameters tables
- Credit recognition: parallel, binary, pulse
- Also available in the tropicalised version to be used in environments affected by adverse weather conditions



Front plates: mod. F1 (60x118 mm)
 F3 (60x152 mm) - F6 (60x180 mm)

RM1000-ADATTA5 vertical adaptor for
 vending machines without coin recycler

Technical Schematics

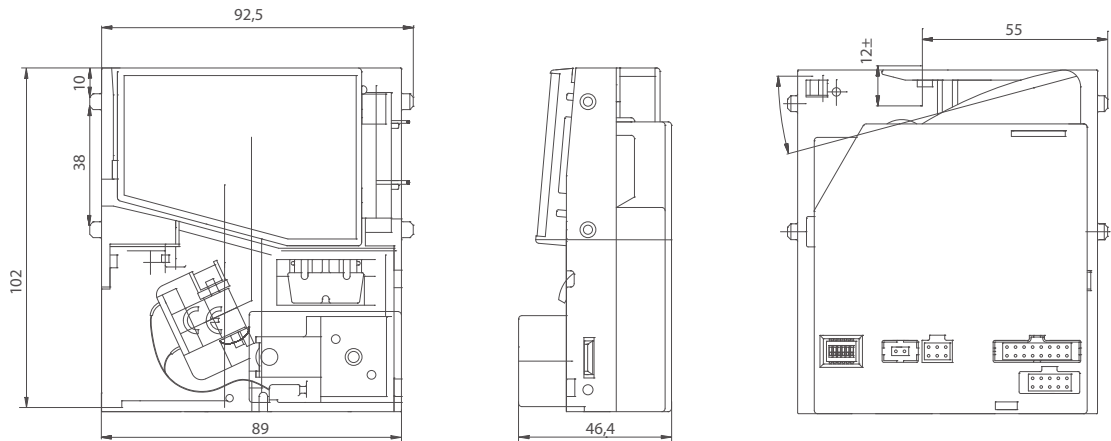

Note: Unit of measure mm

Tools

Clone 5

Programming, configuration and diagnostics software (not to use with the ccTalk Giochi Italia version)



Programmer

Portable tool for on-field programming, configuration and diagnostic operations (not to use with the ccTalk version)



Versions

- 00 Parallel Validator
- 01 Parallel Validator with sorter
- E0 Spain mode validator
- AT Spain mode validator with differentiated time pulses
- B0 Binary Validator
- BC Confida Binary Validator
- 0M Multipulse validator
- 10 2 price totaliser
- 14 1 price totaliser with timed internal reset
- FD Fountain totaliser
- 20 Credit pulse emission totaliser
- 21 Credit pulse emission totaliser with sorter control
- 30 Progressive timer
- 3R Progressive timer with timed credit pulse emission upon request
- 3C Progressive timer with counter outlet
- 40 Totaliser with credit pulse upon request
- 60 Totaliser with timed credit pulse emission upon request
- 70 Single-price multiple sale totaliser

Model	Coin entry	Coin reject
G	Top	Bottom
F	Top or front	Front
B	Top or front	Bottom
V	Top	Front
M	Top or front	Bottom
S	Top	Bottom

Optional accessories

- RM1000-ADATTA5 vertical adaptor for vending machines without coin recycler
- Validator Adaptor from 3½" to 5"
- Front plates: mod. F1 (60x118 mm) - F3 (60x180 mm) - F6 (60x152 mm)
- Special F6 front plate with lock
- Protection for the F6 front plate, to protect against break-in and fraud attempts
- Protection device to protect the RM5 against external agents, such as water or jets
- Coin collection funnels of various heights: 9/16/25 mm
- AGCAVO10P: standard cable to connect the coin validator to the host machine. Available lengths: from 15 to 250 cm
- RMPRINTERF5: cable to connect an RM5 Evolution to a PC in serial mode
- USB SERIAL: cable for converting a serial connection to a USB connection
- Programmer
- USB Kit
- MDB adapter
- Customisable label by quantity

Technical specifications

Dimensions (LxHxW)	89 x 102 x 46,4 mm
Weight	185 g
Power supply	12 ÷ 24 Vdc ± 10%
Power consumption	4W at 12 Vdc
Current consumption	In stand-by: 35 mA max, 12 Vdc During identification: 50 mA max, 12 Vdc During acceptance: 340 mA max, 12 Vdc
Maximum current capacity	200 mA at 24 Vdc ±10% (from channel 1 to channel 4) 800 mA at 24 Vdc ±10% (from channel 5 to channel 6)
Operating temperature	0 °C ÷ 55 °C - 10 ÷ 75% humidity non-condensed (standard version) -25 °C ÷ 70 °C (tropicalised version)
Coins accepted	Ø 16 ÷ 31,5 - Thickness up to 3,3 mm
Recognisable coins	all euro coins from 1 c to 2 €
Acceptance speed	3 coins per second

RM5 HD

Extreme reliability, remarkable acceptance speed and high versatility

5 different sensors and 10 recognition parameters to ensure a high level of recognition and discrimination of valid and counterfeit coins with an unprecedented speed of 6 coins per second (even of different values). Its innovative type of construction ensures strength and durability. The advanced electronic and mechanical anti-fraud systems guarantee excellent security in all installation modes.



Features

- HD high-discrimination system based on 10 different parameters regarding frequency, dimensions and phase
- 5-sensor identification technology: 3 inductive sensors, 1 optical sensor and 1 magnetic sensor
- High acceptance speed: 6 coins per second, even of different values
- Compatible with all coin sorters available on the market
- Advanced electronic and mechanical anti-fraud system: electronic antifishing device, coin movement direction detection, 3 mechanical traps and wire cutting blade
- Indicator LED
- Also available the USB version
- Also available in the tropicalised version to be used in environments affected by adverse weather conditions



Technical Schematics

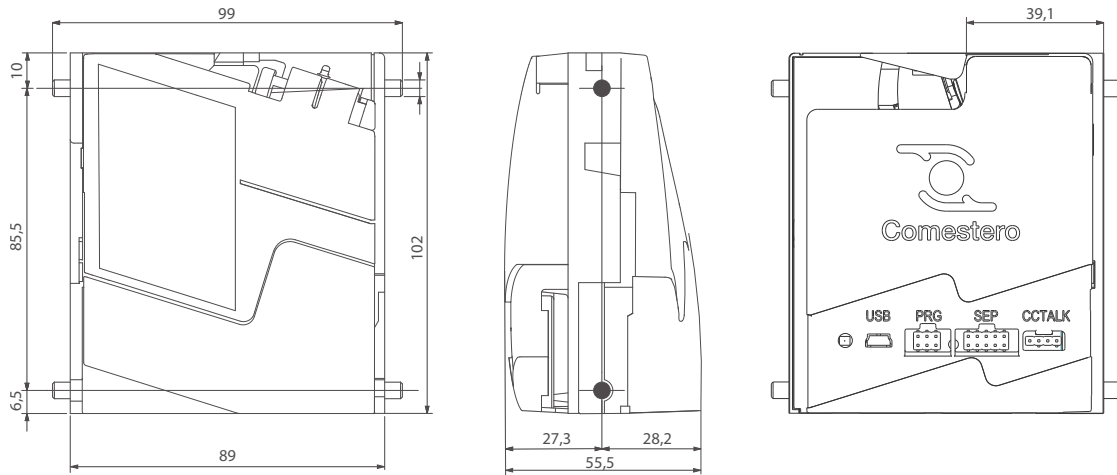

Note: Unit of measure mm

Tools

MultiConfig

Configuration program to be downloaded at suzohapp.com



Virtual Dip Switch

Device for on-field configuration operations



PC Programming Kit

Includes coin validator support, test box, power supply, interface cable and MultiConfig software



Mechanical configurations

Available in two versions, with a different acceptance channel:

- Version A, optimised for the euro, accepting coins with a diameter of up to 27 mm and a thickness of up to 2.4 mm
- Version B, accepting coins with a diameter of up to 31.5 mm and thickness of up to 3.2 mm

The versions are available in four models to meet different installation requirements.

Model	Coin entry	Coin reject
F	Top or front	Front
V	Top	Front
B	Top or front	Bottom / left
G	Top	Bottom / right

Versions

- Parallel Validator
- Parallel Validator with sorter
- Spain mode validator
- Binary Validator
- Confida Binary Validator
- Credit pulse emission totaliser
- Credit pulse emission totaliser with sorter control
- ccTalk Giochi Italia
- ccTalk Full

Optional accessories

- RM1000-ADATTA5 vertical adaptor for vending machines without coin recycler
- Validator Adaptor from 3½" to 5"
- Front plates: available in the versions mod. F1 (60x118 mm) - F6 (60x152 mm)
- Coin collection funnels of various heights: 9/16/25 mm
- RM5 HD PC Kit, including: coin validator support, test box, power supply, interface cable and the MultiConfig software
- Virtual Dip Switch
- Customisable label by quantity

Technical Specifications

Dimensions (LxHxW)	99 x 102 x 55.5 mm
Weight	200 g
Power supply	12 ÷ 24 (±10%) Vdc
Current consumption	Stand by: max 70mA During acceptance: max 400mA
Operating temperature	0 °C ÷ 55 °C - 10% ÷ 75% humidity non-condensed (standard version) -25 °C ÷ 70 °C (tropicalised version)
Coins accepted	Ø 16 ÷ 27 mm; max thickness 2.4 mm (Standard) Ø 16 ÷ 31.5 mm; max thickness 3.4 mm (with acceptance channel: 4.5 mm)
Acceptance speed (without sorter)	Up to 6 coins per second
Acceptance rate	95% + first insertion 98% + second insertion
MTBF (Mean Time Between Failure)	at 25°C is around 170,000 hours

EuroKey Next

The master key of the cashless payment systems for electromechanical equipment

EuroKey Next is the cashless device to manage the keys and media based on the Mifare® technology. The EuroKey range ensures high reliability in compliance with the WorldKey safety standards. Extremely flexible, it can manage both the MDB and EXE communication protocols. Also available in the PARALLEL version for applications in car wash stations, self-service laundrettes, tourist and sport facilities. EuroKey Next sets promotional campaigns and discounts, even based on time slots, to build customer loyalty and increase sales.



Features

- Keys/cards/tags reader
- Equipped with red light signal with 3 status LEDs and infrared interface to collect audit data
- Maximum compatibility with EuroKey and WorldKey systems
- Possibility to manage EuroKey keys and Mifare® media
- Supported protocols: MDB, EXE
- Management of RM925, KPD, KPM input/output electronic boards and the 4-digit RM924 display
- Automatic key/card/tag activation
- Micro USB port for PC connection, firmware update, and audit data collection
- Configuration and accounting data management through the Unico software and IRDA interface
- Dual installation: front-panel and back-panel mounted by means of special adjustment plate



EuroKey Next is extremely flexible and can manage both the MDB and EXE communication protocols. Also available in the PARALLEL version for applications in car wash stations, self-service laundrettes, tourist and sport facilities

Technical Schematics

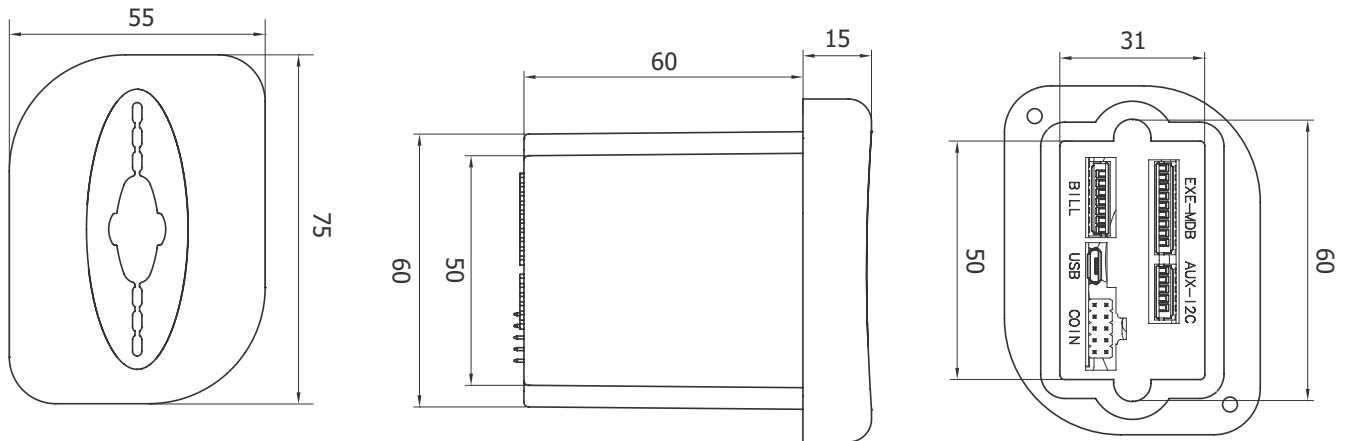

Note: Unit of measure mm

Functionality

- 3 codes management (manager, renter, machine)
- Maximum value management
- Second MDB address (MDB mode) management
- 3 prices management (EXE mode)
- Direct coin validator and banknote reader management (EXE mode)
- Machine No. modifiable by the user
- Differentiated key management
- Black list management
- Bonus management
- Time slots management
- Accounting data management
- On-field firmware update

Tools

UNICO configuration program

Software suite which includes programs for audit data collection and management (according to EVA-DTS standard or Windows Excel), operating parameter programming and key/card/tag management

Portable universal programmer (UHHT)

For on-field programming through micro USB cable connection



Programming Key & Clone Programming Key



Audit Key



Versions

Compatible with the old Eurokey Plus Parallel versions: standard single-price and standard multi-price

Optional accessories

- Portable universal programmer (UHHT)
- Customisable keys, cards and tags by quantity
- Complete installation starter kit
- Back panel mounting kit
- LCD Display
- Countertop recharging box



Technical specifications - CPU

Dimensions (LxHxD)	55 x 75 x 77 mm
Weight	90 g
Power supply	18-40 Vdc 105mA 18-27 Vac 50/60 Hz 170 mA
Power consumption	3.2 W
Operating temperature	-10 °C ÷ +50 °C
Humidity (non condensed)	85%
Storage temperature	-10 °C ÷ +60 °C

Technical Specifications – keys/cards/tags

Technology

EuroKey keys

125 KHz Transponder

Mifare® keys/cards/tags

13.56 MHz inductive transmission system, ISO 14443 data and energy – Mifare® encrypted

WorldKey

Private cashless payment system and powerful customer management tool

The WorldKey system uses the Mifare® (standard, Plus, DesFire, NFC) technology platform to ensure high safety standards and management of multiple applications. Security in transferring data is ensured by the combination of the proprietary encryption Mifare® and RFTech TDES (Triple Data Encryption Standard). Thanks to WorldKey, the operators can manage several sales or identification applications (access to multiple services also of different operators), storing them on a single RFID support (card/key/tag/sticker). The applications can be used within a single infrastructure or extended to different businesses, either visibly or hidden. WorldKey supports the most used protocols (Executive, MDB, BDV) and is ready to integrate the Ethernet, RS485, CAN BUS, ccTalk and USB interfaces.



The reading device is available in 3 versions:

- Moon: only with key/tag insertion. Supplied with two different front panels: round and oval, ideal for retrofitting
- Sky: card insertion plus key/tag
- Galaxy: with card in tap & go mode plus key/tag insertion

Features

- System including one CPU unit and a reading device connected by a “smart” coaxial cable (patent pending)
- CPU equipped with micro USB port for connecting a PC or for piloting an external device or the Universal hand-held programming device
- Reading devices equipped with: semaphore signals according to the EVA-CVS standard with 3 status LEDs (red, yellow, green) and buzzer. Infrared interface to collect audit/log data and program the readers
- Supported vending protocols: Executive master/slave, MDB master/slave and BDV master/slave
- Automatic activation of cards/keys/tags upon first insertion
- Possibility of connection with WiFi module for audit data

Functions

- Different prices management
- Sales prices (80x3 cashless prices + 80 cash prices)
- Single cash sales or multiple cash sales
- 3 security codes management (operator, rental, machine)
- Machine No. modifiable by the user
- Maximum value management
- Differentiated key management
- Black list/white list/log file management
- Time slots management
- Bonus management
- Accounting data management
- On-field firmware updating
- Remote management via Ethernet
- USB on the go
- CAN BUS connector
- RS485 connector
- Parallel banknote reader management
- Parallel coin validator management

Versions

- EXE/EXE also in BDV
- EXE/MDB also in BDV
- MDB/MDB
- MDB/SLAVE

Tools

UNICO configuration program

Software suite which includes programs for audit data collection and management (according to EVA-DTS standard or Windows Excel), operating parameter programming and key/card/tag management

Software for card management (code RFT-CARD-SW)

Software for audit and log management (code RFT-AUDIT-SW)

Universal hand-held programming device

For on-field programming through micro USB cable connection

Programming Key & Clone Programming Key

Audit Key



Optional accessories

- Customisable RFID keys/tags/cards/stickers by quantity
- Credit Box for transferring credits
- LCD display
- Printer
- Countertop recharging box





Moon
Reading device for keys and tags
(Round front plate)

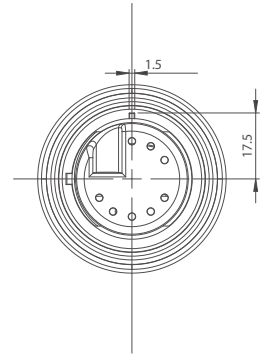
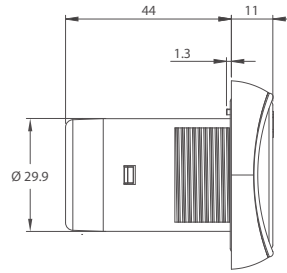
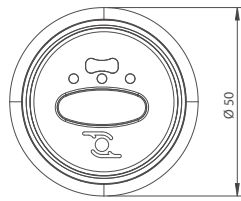

Moon
Reading device for keys and tags
(Oval front plate)

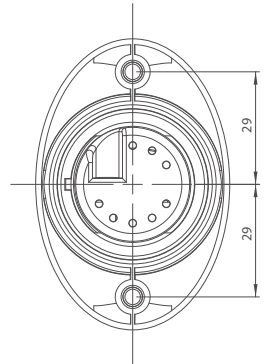
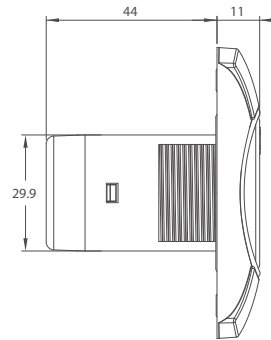
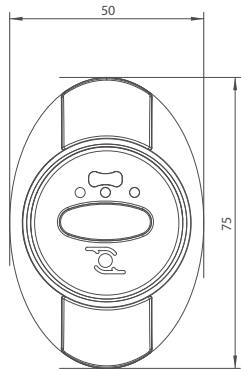

Sky
Reading device for keys, tags
and insertion cards

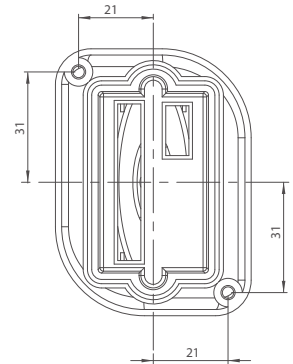
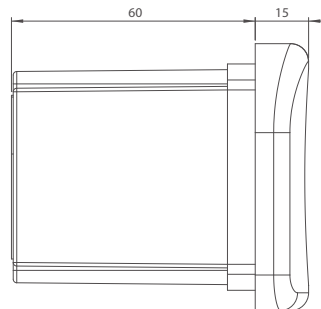
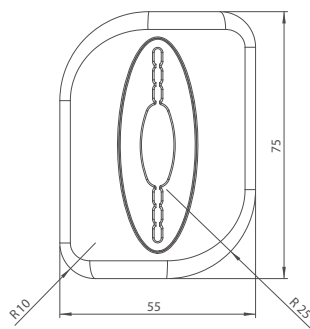

Galaxy
Universal reading device
for keys, tags and tap & go cards

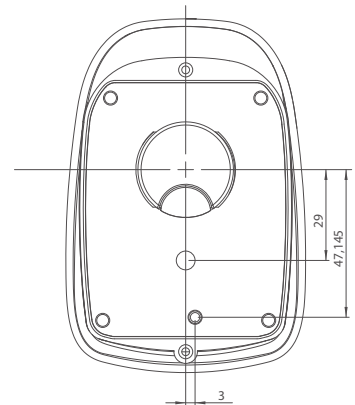
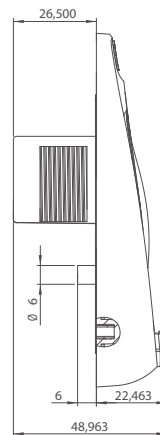
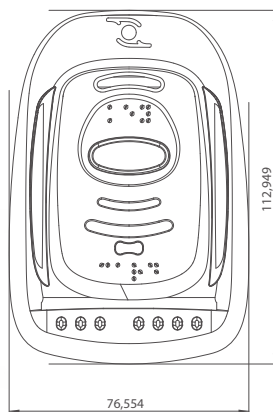

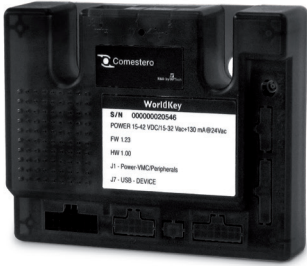

WorldKey
CPU

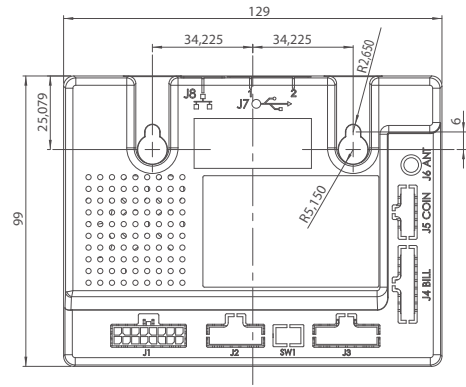
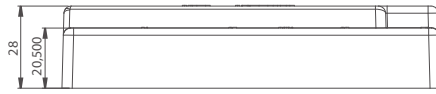

Payment supports



Customisable **Keys** by quantity



Customisable **Cards** by quantity



Wide range of **Tags** available in different shapes and colours

Technical Specifications - CPU

Dimensions (LxHxW)	129 x 99 x 28 mm
Weight	200 g
Power supply	15-40 Vdc - 12-27 Vac (50-60 Hz)
Power consumption	3.75W without peripherals
Operating temperature	-20 °C ÷ 50 °C
Humidity (non-condensed)	90%
Storage temperature	-20 °C ÷ 70 °C



Customisable **Stickers** by quantity



Happy: new customisable tags by quantity

Technical Specifications - reading devices

	Moon (Round front plate)	Moon (Oval front plate)	Sky	Galaxy
Dimensions (LxHxW)	50 x 50 x 55 mm	50 x 75 x 55 mm	55 x 75 x 75 mm	77 x 113 x 50 mm
Weight	45 g	45 g	60 g	90 g
Operating temperature	-20 °C ÷ 50 °C	-20 °C ÷ 50 °C	-20 °C ÷ 50 °C	-20 °C ÷ 50 °C
Humidity (non-condensed)	90%	90%	90%	90%
Storage temperature	-20 °C ÷ 70 °C	-20 °C ÷ 70 °C	-20 °C ÷ 70 °C	-20 °C ÷ 70 °C

Technical Specifications - keys/cards/tags

Technology used	ISO 14443 – MIFARE® encrypted data and energy induction transmission
Transmission frequency	13.56 MHz

Easy Pay Recharging Unit



Features

- Compact reading device for Mifare® cards
- Portable unit to simplify cashpoint operations and charge cards, keys and tags in an easy way
- Functionality:
 - Key/Card/Tag management
 - Recharge – Decrease user cards
 - Price table management
 - Recharge bonus management
 - Use of Programming/Audit keys
 - Use of Black - Access List
 - Possibility to print a barcode for the activation and payment of different services

Tools

UNICO configuration program

Software suite which includes programs for audit data collection and management (according to EVA-DTS standard or Windows Excel), operating parameter programming and key/card/tag management

Optional accessories

Customisable cards, keys, tags and stickers

Versions

- **Mobile:** portable version with rechargeable battery
- **Mobile QR:** portable version with rechargeable battery and bar code function
- **Combi:** desktop version

Technical Specifications

Dimensions (LxHxW)	216 x 86 x 95 mm
Weight	525 g
Power consumption	40 VA
Power supply	8.2V DC
Operating temperature	-5 °C ÷ 50 °C
Humidity (non-condensed)	90%
Storage temperature	-20 °C ÷ 80 °C

Electronic boards

A wide range to satisfy all modularity demands

These boards facilitate the use of coin and banknote validators in their various sectors of use and allow to combine them with other types of payment systems, such as cashless systems.

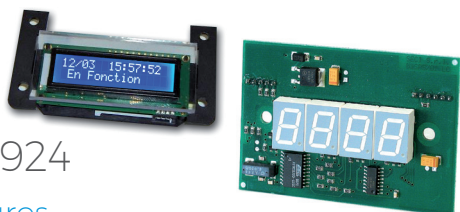

RM 924

Features

- 4-digit display managed by an RM5 coin validator or by RM 925 boards (dedicated versions)
- It can also be managed by the parallel version of the cashless system or by the KPM and KPD multi-price boards

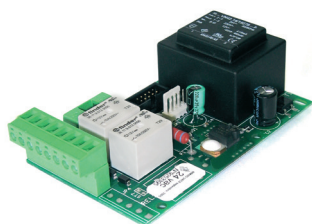

RM 925

Features

- It interfaces the RM5 electronic coin validator or the cashless system, parallel single-price version, with electro-mechanical equipment
- Ideal for automating service payments
- Provides the power supply for the coin validator or the cashless system, as well as for the display (if any)
- It is equipped with two relay outputs: a third relay is available as an option to control an external service
- Available in different configurations according to the power supply and the coin validator model

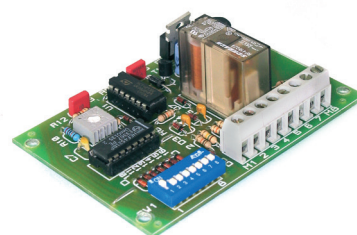

B 904

Features

- Timer for mechanical coin validators
- Provides a time proportional to the number of inserted coins. Time can be set via the dip-switches on the board
- Available in 2 different configurations according to the type of power supply: B 904/E1142/A at 220 or 24 V and B 904/E1131/E at 24 V

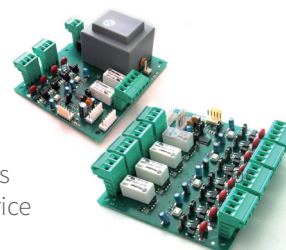

KPD/KPM

Features

- They manage 2 and 4 prices cashless system in multi-price parallel version
- They control the activation of machines in self-service laundrettes car washes, etc., or, in general, they manage 6 time-set services simultaneously (lighting, showers, etc.) with the cashless system with transponder keys/cards
- It connects an RM5 coin validator, for making payments or for recharging user keys, and an RM 924 display

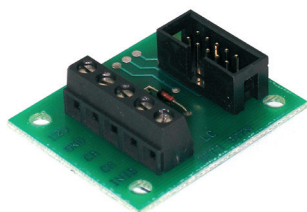

RM 927

Features

- Facilitates the connection of a coin validator with credit pulse emission totaliser to any equipment
- Equipped with a 5-pole terminal board for easy wiring operations or connection to a board



Worldkey Move

Features

- CPU equipped with 2 relay outputs and 4 inputs
- The ideal solution for managing electromechanical equipment
- Compatible with QR code reader

Tokens

Made from special alloys and with wide customisation options

Over 70 different models, designed to guarantee perfect discrimination and selection, using only the best materials. The monometallic and bimetallic tokens, made from special long lasting alloys, are designed for intensive use on machines with electronic coin validators.

The grooved tokens on the other hand, made from copper and nickel plated steel, are ideal for machines with mechanical coin validators: coin entry plates suited to each token are available for these applications. What's more, each model can be customised by diameter, thickness and coining to be truly distinctive while adding value to the customer's activity: upon request, tokens can be marked with a message or company logo, in relief or in negative, to make them even more prestigious.



Monometallic

- Particularly sturdy and wear-resistant thanks to the long-lasting materials with which they are made: whit brass alloy, nickel-silver, iron or zama
- Diameter from 18 to 31 mm

Bimetallic

- Consisting of a core and a copper alloy surrounding ring: the colour contrast creates an exclusive special effect
- Diameter from 26 to 27 mm (other sizes upon request)



Grooved

- Made of iron or zama, they have one or more grooves on either the front or back
- Diameter from 22 to 27.8 mm

Themes

4 different graphic theme available: zodiac, cars, historical monuments and African animals



Coin entry covers

Different coin entry plates are available according to the token to be inserted.

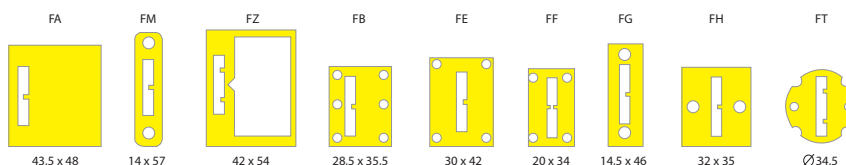

Notes

A series of horizontal dotted lines for writing notes.

Copyright 2017
SUZOHAPP
All rights reserved

No part of this catalogue may be reproduced in any form by print, photoprint
or any other means, without written permission from the publisher.
Technical data, text and pictures are subject to error and modifications.
The catalogue can be subject to further developments.

